

MOTAK

Mobile Ice Cream Freezer

Model #: MSD-180

Product Details

- CFC free refrigerant and 2.5" foam insulation
- Mechanical Thermostat adjust from -15°F to 8°F
- Drainage is in rear
- Fast freeze time
- Flat Sliding Glass Doors-Top LOW-E Tempered Glass for easy view. Locks & Keys included.
- Removable PVC coated baskets included for easy organizing
- Uses R290 refrigerant, which is eco-friendly and more efficient
- Low noise level
- Internal coved corners, easy to clean
- Big casters for easy moving
- Manual Defrost



Plan View

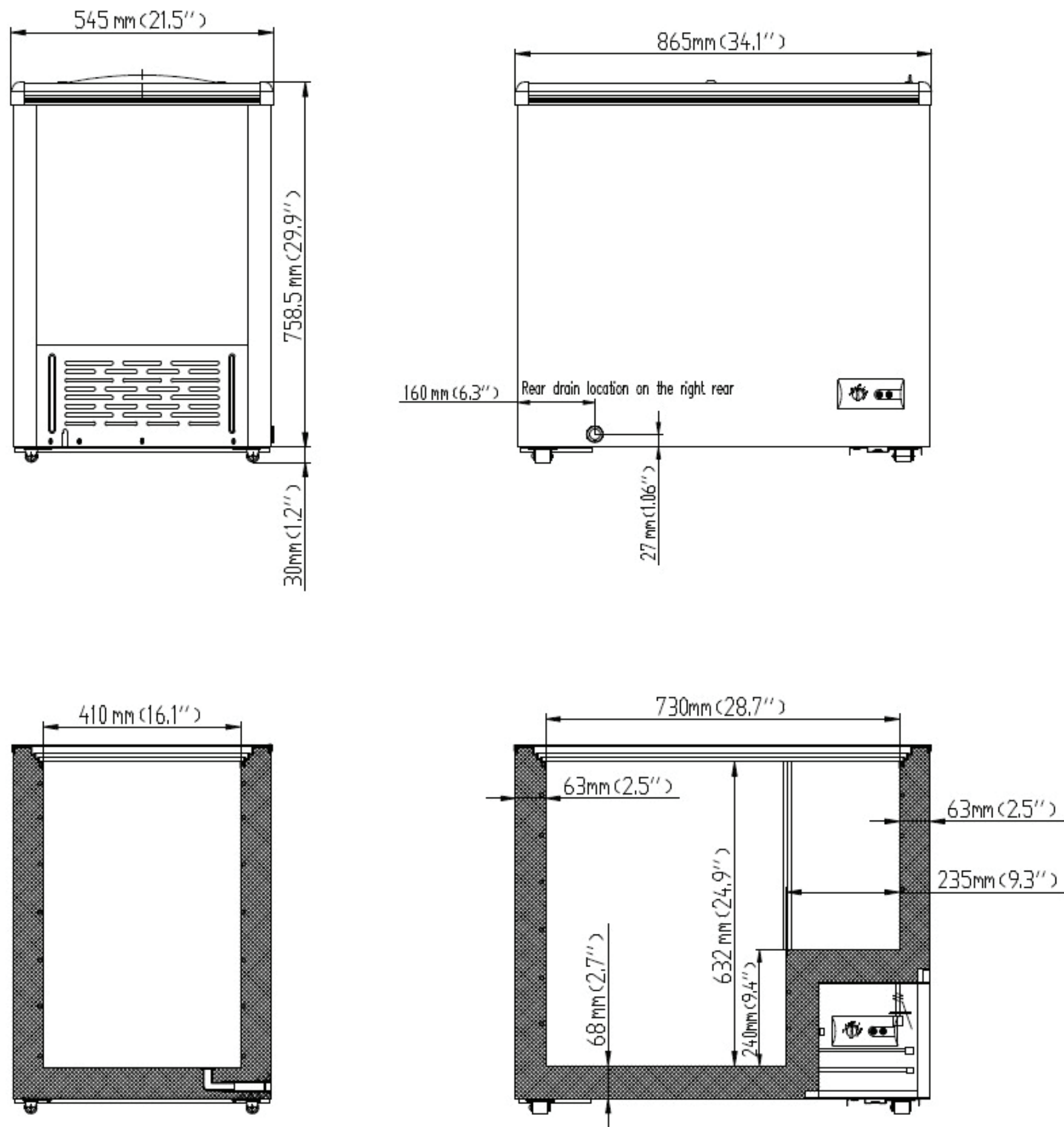

Not suitable for installation in non-commercial or residential applications.

Certifications



Specifications

| Model | # OF DOORS | # OF BASKETS | APPX. STORAGE CAP. [CU/FT] | CABINET DIM [IN] | | | HP | VOLTAGE/Hz/ph | AMP | NEMA PLUG | CORD LENGTH (FT) | UNCRATED / CRATED WEIGHT |
|---------|------------|--------------|----------------------------|------------------|------|------|-----|---------------|-----|-----------|------------------|--------------------------|
| | | | | W | D | H | | | | | | |
| MSD-180 | 2 | 2 | 5.3 | 34.1 | 21.5 | 31.1 | 1/4 | 115/60/1 | 2.0 | 5-15P | 6 | 80/91 |