

# MOTAK

## Countertop Gas Range

Model #: **MHP -12, -24, & -36**

With 25,000-BTU high-heat burners, MoTak countertop gas ranges provide commercial cooking space without an oven or other base. The burners give you the maximum in gas range features, including burners with removable tops for easy cleaning and a pilot that lights each burner. Heavy-duty cast iron grates are also removable for easy cleaning.

A large control knob for each burner gives you a comfortable feel when turning burners on and off all day. Units are shipped for natural gas but are easily converted to LP (propane) gas with the LP conversion kit that is included.

These countertop gas ranges carry ETL Gas and Sanitation approvals, which means they meet U.S. gas and sanitation requirements for use in restaurants.

**Not suitable for installation in non-commercial or residential applications.**

## Warranty

WARRANTY: 1 Year Parts & Labor

## Certifications

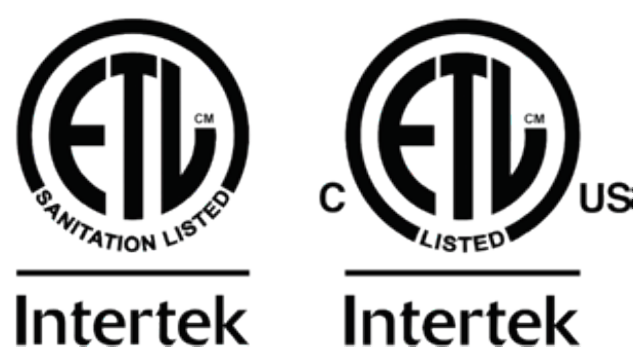

## Product Details

- High-performance & efficient 25,000-BTU burners
- Heavy-duty cast iron burners
- Removable burner grates for easy clean up
- Individual, adjustable pilots on each burner
- Extended cool-to-touch front edge
- Easy-to-clean, full-width, stainless grease pan
- Adjustable, non-skid stainless steel legs

MOTAK reserves the right to make changes to the design or specifications without prior notice.

APR2221





# MOTAK

## Countertop Gas Range

Model #:  
MHP12  
MHP24  
MHP36

- A pressure regulator is provided with this unit.
  - Natural Gas 4.0" W.C.
  - Propane Gas 10.0" W.C.
- Gas connection is ¾" NPT (19mm) rear gas connection.
- All equipment is supplied ready for natural gas with an LP conversion kit included.

### Plan View

MHP12 - Front View

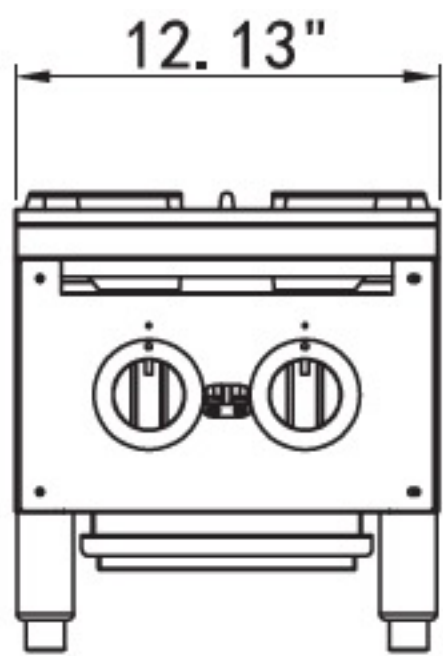

MHP24 - Front View

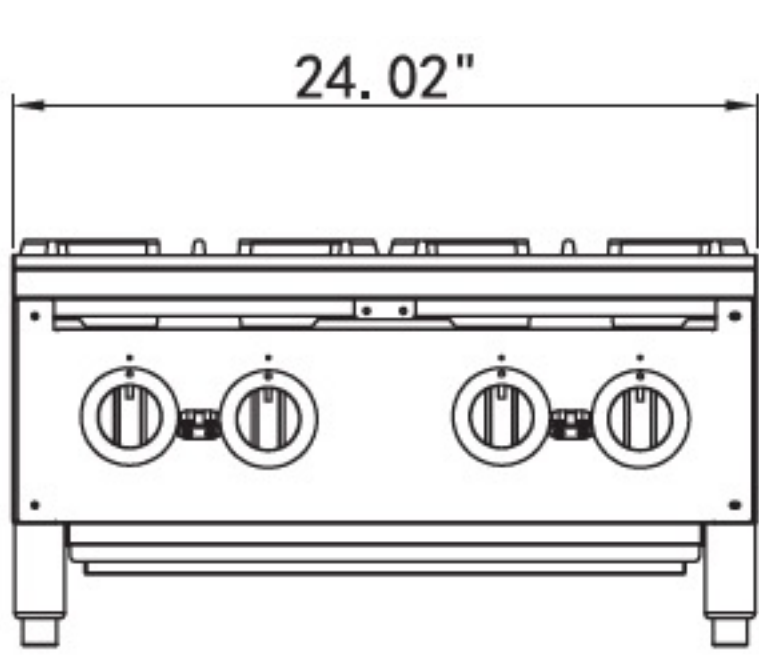

MHP36 - Front View

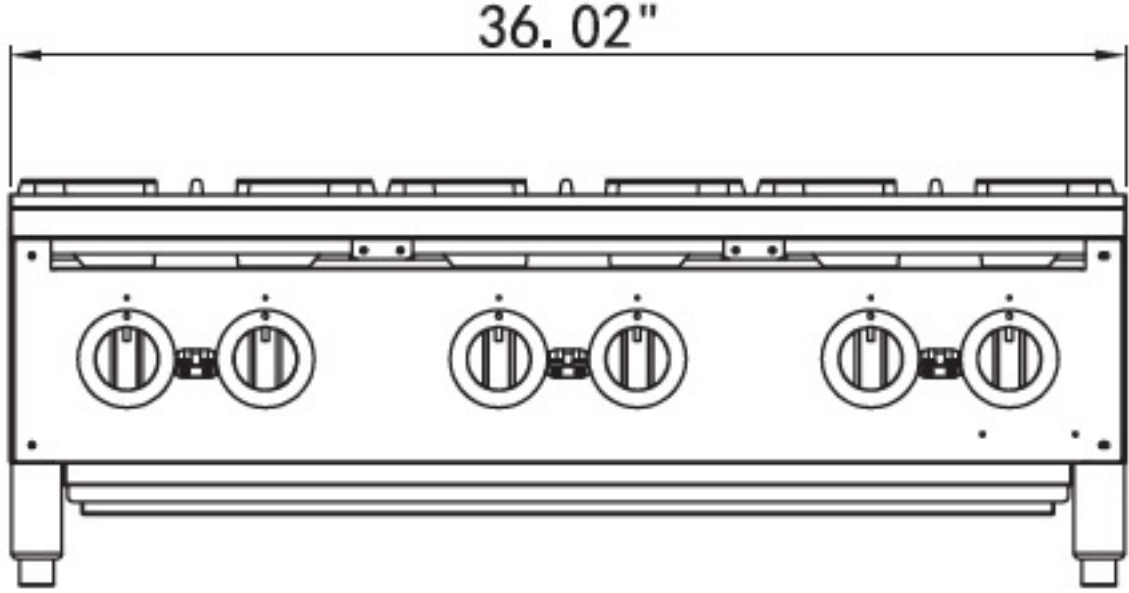

Side Views

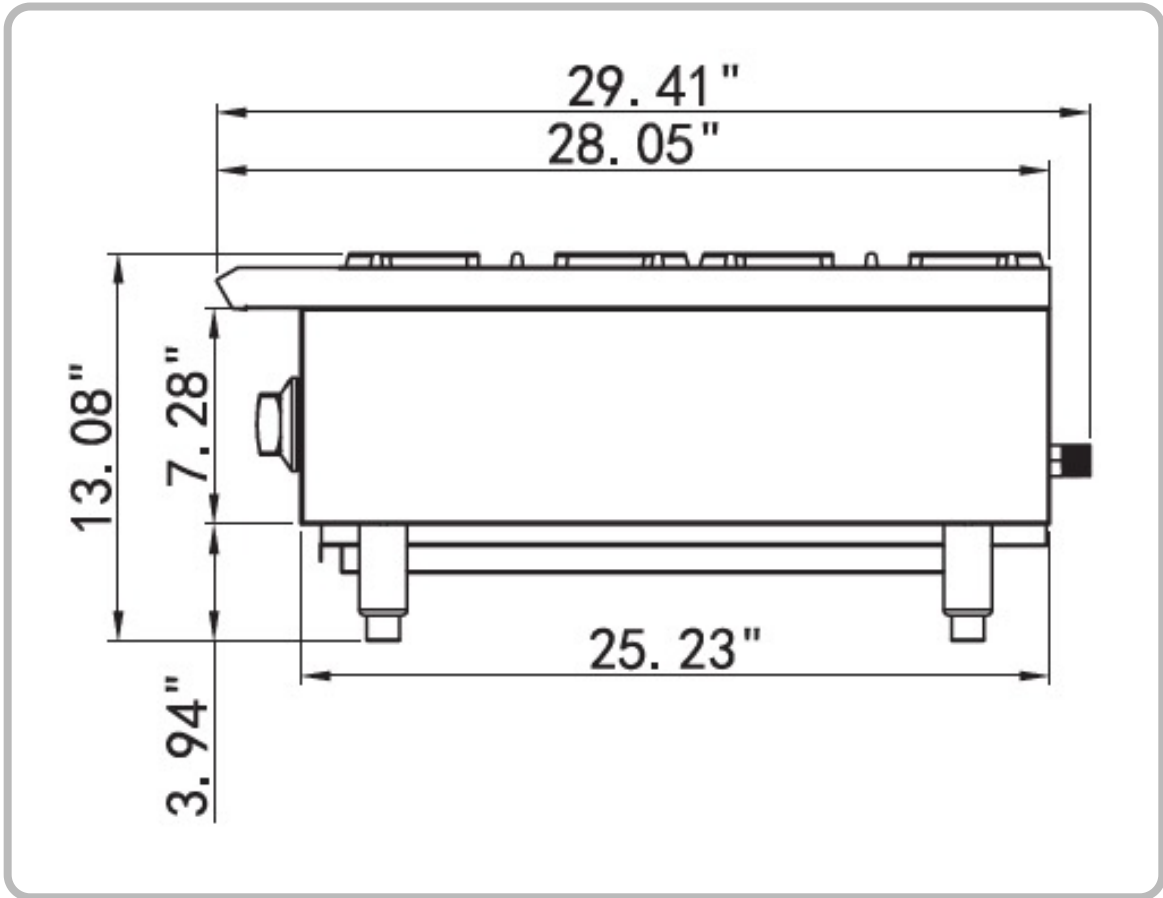

MHP12- Top View

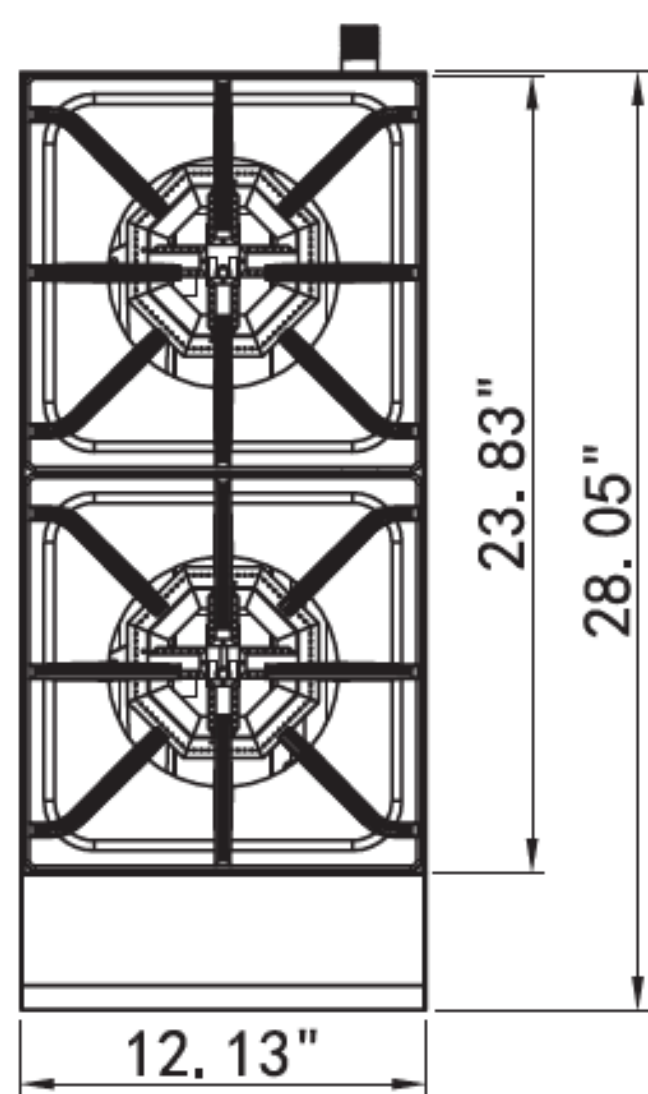

MHP24 - Top View

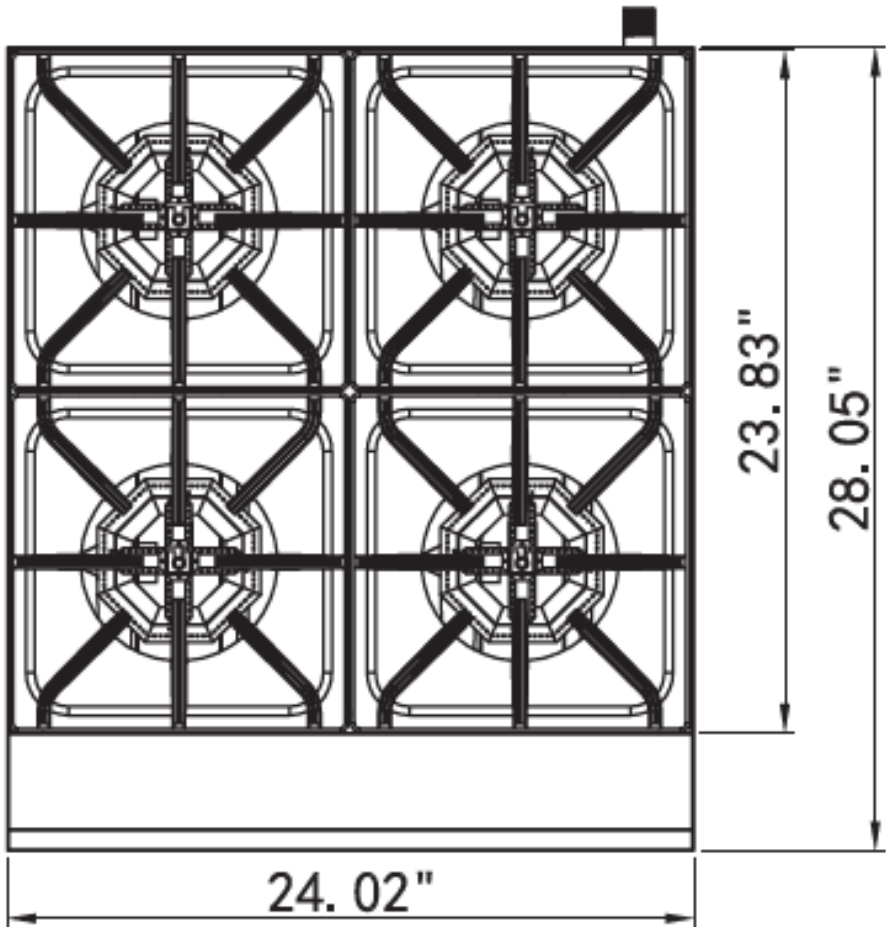

MHP36 - Top View

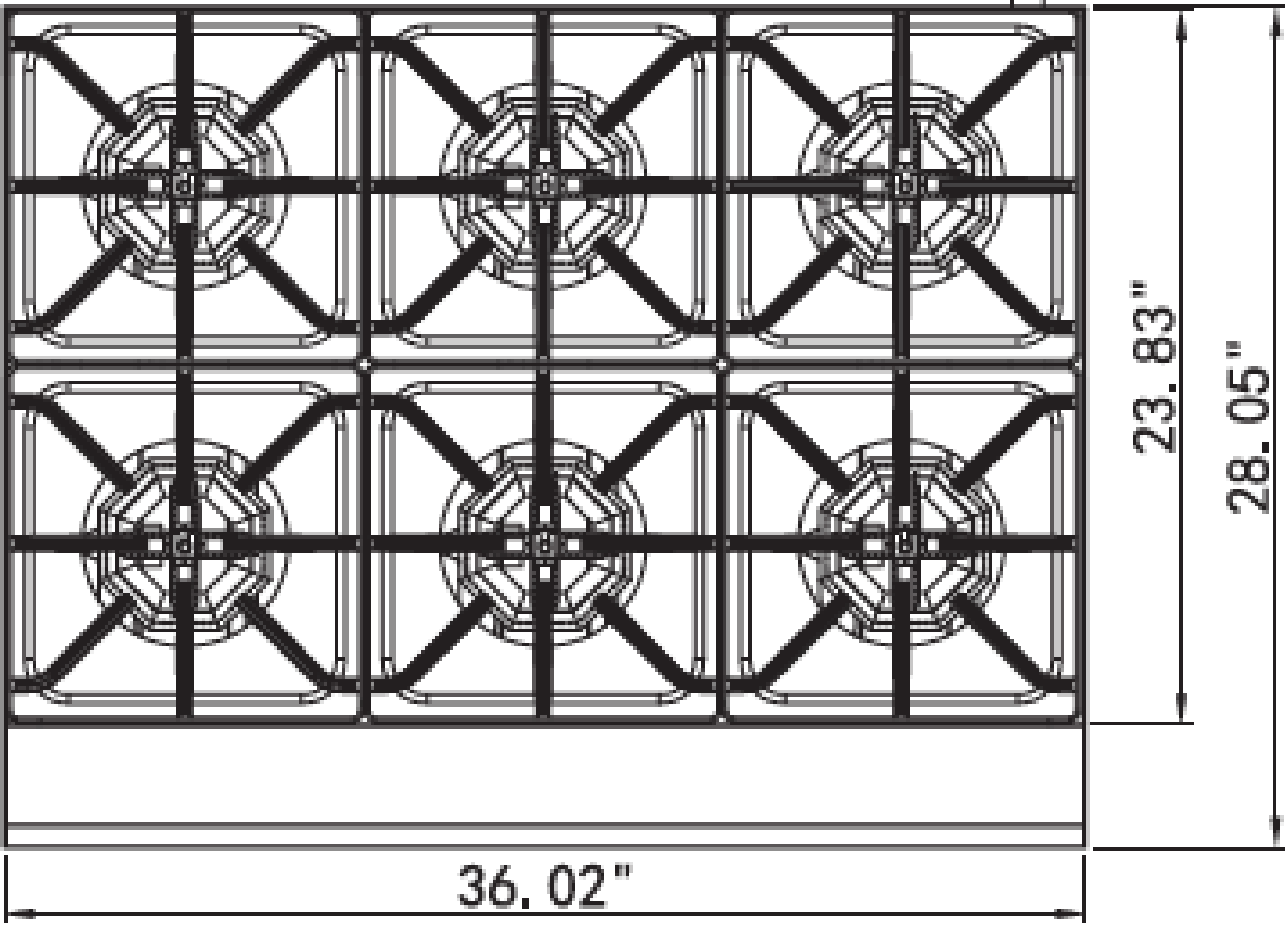

### Specifications

Model	Burners	Dimensions			BTUs Per Burner	Total BTUs	Crated Weight (lbs)
		Width	Depth	Height			
MHP12	2	12.13"	29.41"	13.08"	25,000	50,000	86 lbs.
MHP24	4	24.02"	29.41"	13.08"	25,000	100,000	168 lbs.
MHP36	6	36.02"	29.41"	13.08"	25,000	150,000	243 lbs.

Not suitable for installation in non-commercial or residential applications.

MOTAK reserves the right to make changes to the design or specifications without prior notice.