

DRAIN AND RINSE

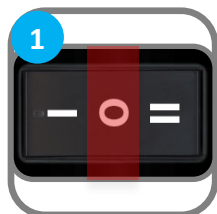

Switch to OFF



Remove Hopper Agitator (Optional)

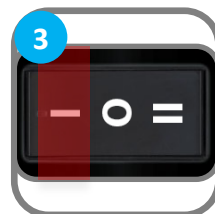

Switch to WASH



Drain Product

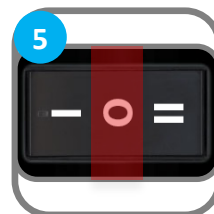

Switch to OFF



Add 7.57 Liters (2 Gallons) of Water to Hopper



Scrub Sides and Bottom of Hopper

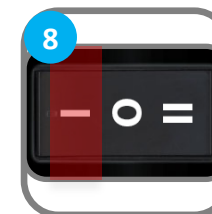

Switch to WASH



Drain Water

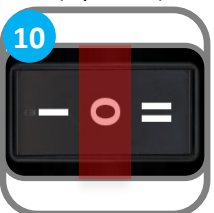

Switch to OFF



Repeat Steps 6-10 Until Water is Clear



CAUTION: NEVER use warm water or a dish washer when rinsing and cleaning the machine and its components.

DISASSEMBLE & CLEAN



Remove Torque Arm



Remove Dispensing Door Hand Screws



Remove Dispensing Door

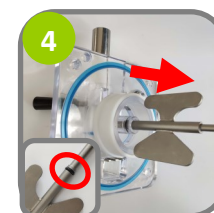

Remove Torque assembly and O-ring



Remove Dispensing Door Gasket



Remove Valve Pin and Draw Handle



Rotate Draw Valve



Remove Ice Buster



Rotate and Remove Draw Valve



Remove Draw Valve O-Rings



Remove Prime Plug



Remove Beater Assembly



Remove End of Seal



Remove Front Drip Tray



Remove Internal Drip Tray



Scrub Cylinder w/ Large Brush



Scrub Hopper Sides and Bottom



Scrub Hopper Feed Tube and Agitator

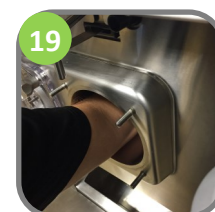

Thoroughly Clean Rear of Cylinder



Clean and Wipe Down Exterior



Wash all Parts

ASSEMBLE



Install Drip Trays



Install Hopper Agitator (Optional)



Lubricate and Install End of Seal



Install Beater Assembly



Rotate to Lock in Place (Beater Fully Inside)



Lubricate Draw Valve



Install Draw Valve

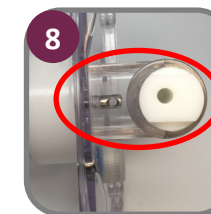

Rotate Draw Valve to Install Ice Buster



Install Ice Buster



Make Sure the Draw Handle Hole is Accessible



Install Draw Handle and Valve Pin



Install Prim plug



Install and Lubricate Door Gasket

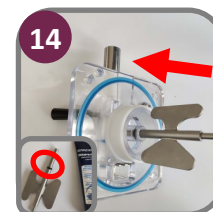

Install and Lubricate O-Ring; Install Torque Assembly



Make Sure the Torque Hole is Facing Up



Install Dispensing Door Assembly



Tighten Dispensing Door Hand Screws



With tapered end down, install torque arm up through the sensor pin hole under the overhead and then down into the torque assembly; torque arm should move freely back and forth.



SANITIZE AND ADD PRODUCT

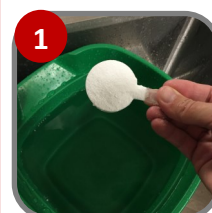

Mix 7.57 Liters (2 Gallons) Sanitizer Solution

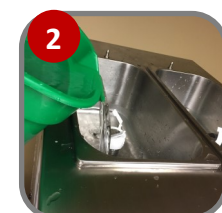

Pour 7.57 Liters (2 Gallons) Sanitizer into Hopper

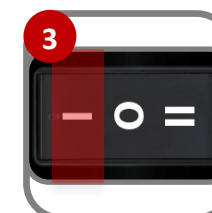

Switch to WASH



Scrub Hopper Sides and Bottom



After 5 to 10 Minutes Drain Sanitizer

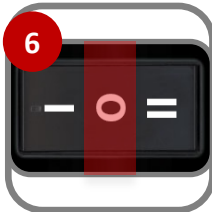

Switch to OFF



Add 2 Liters (1/2 Gallons) Product

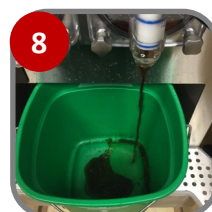

Open Draw Valve to Flush Sanitizer and Close Draw Valve



Open Prime Plug



Add Minimum 9.46 Liters (2 1/2 Gallons) of Product



Close Prime Plug



Switch to FREEZE