

Energy efficient, eco-friendly hydrocarbon refrigerant with low charge, spark-free components, providing the greatest reliability. Designed with detailed quality to meet all food safety requirements of the foodservice industry.



## KEY FEATURES



### **Electronic Temperature Control**

Ensures optimal equipment performance by maintaining products at the ideal temperature for consumption.



### **Eco-Friendly Refrigerant**

Environmentally friendly hydrocarbon refrigerant has low Global Warming Potential (GWP). Meets all USA refrigerant and energy standards.



### **Electronic Fan Motors**

These motors provide improved performance by using only a fraction of the energy required by shaded pole motors.



### **LED Lighting**

Our patented LED system uses a fraction of the energy and has over ten times the lifespan compared to a fluorescent light bulb.



### **Stainless Steel Material**

High-quality material for food preservation, complying with safety and hygiene standards.

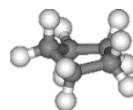

### **Cyclopentane Insulating Foam**

It is eco-friendly as it does not contain Chlorofluorocarbons (CFC) or Hydrofluorocarbons (HFC) and is a highly efficient insulator.

## TECHNICAL SPECIFICATIONS

Exterior Dimensions		Interior Dimensions		Usable Interior Capacity	
H: 83 1/8"	211 cm	H: 61 3/8"	156 cm	H: 54 3/4"	139 cm
W: 52 3/4"	134 cm	W: 48 1/8"	122 cm	W: 47 1/4"	120 cm
D: 35 3/8"	90 cm	D: 27 1/8"	69 cm	D: 25 1/4"	64 cm
Usable Volume		49 ft <sup>3</sup>	1387.5 lts		
Doors		2			
Door construction		Solid Stainless			
Shelves		6			
Shelves Size		22 3/4"	57.7 cm		
		24 5/8"	62.5 cm		
External Material		Stainless Steel			
Internal Material		Stainless Steel			

## REFRIGERATION PERFORMANCE DATA

Refrigerant	R290 3.4 Oz (0.095 kg)	
Energy Consumption	2.45 kWh/24h	
Compressor Power	1/3 HP	
Condenser	Dynamic	
Thermostat setting default	44.6°F (7°C)	32°F (0°C)

## ELECTRICAL DATA

Power supply	115V / 60 Hz	
AMPS	3.6 A	
Cord length	118" (300 cm)	
Lighting	2 module, 72 LED per strip	
Plug type	NEMA 5-15P	
Controller	CIR EVO 2V0	

## LOGISTIC DATA

Trailer Loads	53': 27	
Unit weight	Gross	Net
	230.5 kg 508 lb	220.4 kg 486 lb
Dimensions w/packaging	H: 90 1/2"	230 cm
	W: 58 5/8"	149 cm
	D: 36 5/8"	93 cm

\*Energy consumption based on ANSI/ASHRAE Standard 72-2005.  
 \*Dimensions rounded up to the nearest inch or centimeter.  
 \*Specifications subject to change without notice.  
 \*H:Height, W:Width, D:Depth  
 \*Specifications subject to change without notice.

CONTACT INFORMATION  
 IMBERA | 1925 Shiloh Road, Building #2 Kennesaw, GA 30144  
 P: 678-504-6835

## PRODUCT VIEWS

Top view

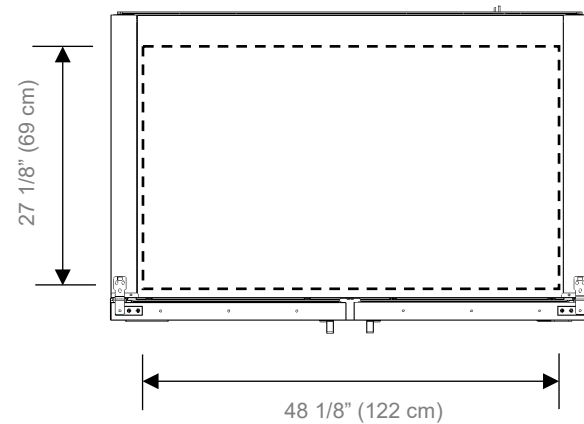

Front view

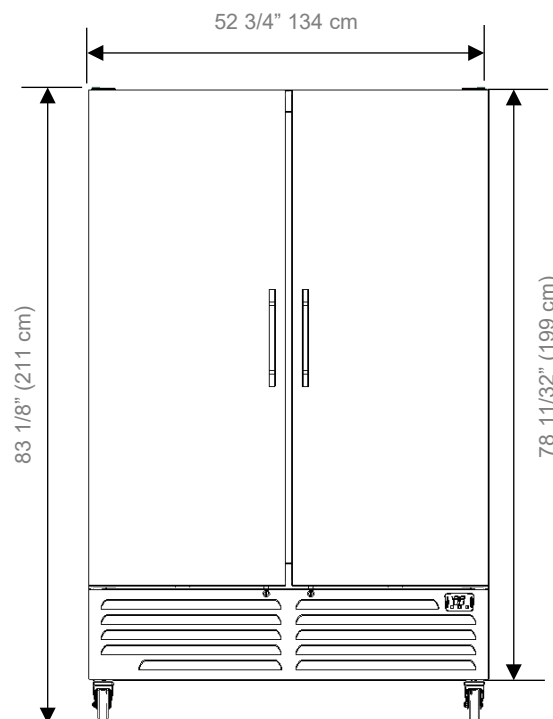

Side view

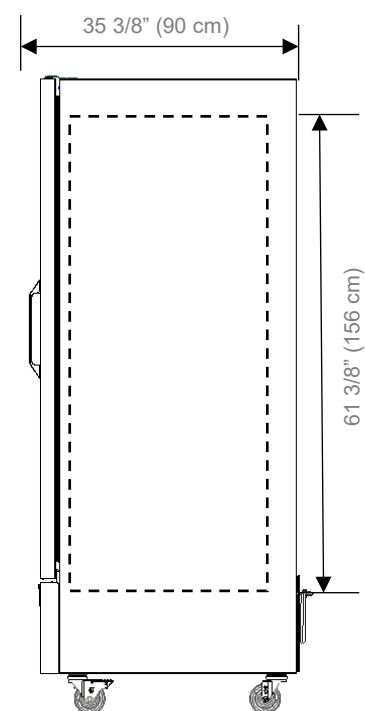

## ADDITIONAL FEATURES

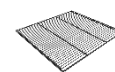

**Black epoxy shelves**



**Mechanical Lock**



**4" Pre-installed Casters**

### Customer Service and warranty

Five-year limited warranty, includes parts and labor.  
 An additional two-year warranty is issued on the compressor (USA & Canada only).  
 Operators must follow installation and operational guidelines per Imbera User's Manual.  
 It is essential that each cooler is directly connected to a single power supply; failure to do so will result in voiding the warranty.  
 Customer service: 866.548.5770

24/06/2025