



Model: **16-151L** Item #: \_\_\_\_\_ Date: \_\_\_\_\_  
Project: \_\_\_\_\_ Qty: \_\_\_\_\_ Approved By: \_\_\_\_\_

## Dipperwell Faucet

Royal Series



### DESCRIPTION

- Single Hole Deck Mount Dipperwell Faucet, Polish Chrome Finish

### STANDARD FEATURES

- Polished chrome cross handle knob
- 1/2" NPS inlet with included 1/4" NPT tailpiece
- Warranty: 3 years

### SPECIFICATIONS

Water Inlet	1/2" NPS
Temp. Range	40°F - 140°F
Pressure	20-120 PSI
Rough In	7/8" Hole
Flow Rate	1.33 GPM (at 60 PSI)
Material	Solid Brass
Finish	Polished Chrome
Weight	1 lbs.

### PRODUCT COMPLIANCE

- NSF-61 & NSF/ANSI 372
- ASME A112.18.1-2012/CSA B125.1-12
- Massachusetts Approved
- CEC Approved

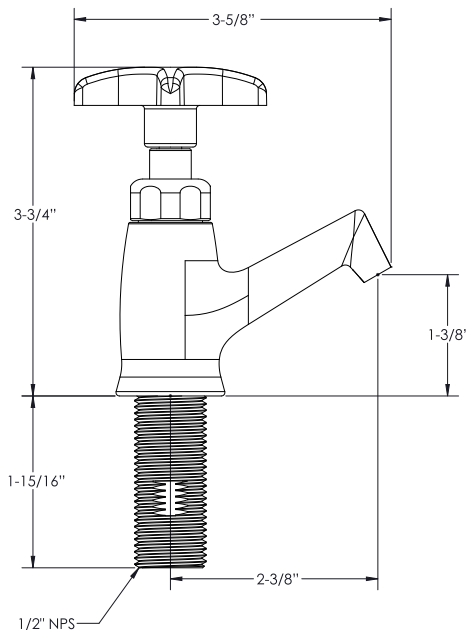

**WARNING:** Plumbing connections should be made by qualified personnel who will observe all applicable plumbing, sanitary and safety codes.  
California Proposition 65 Warning

Krowne Metal Corporation • 100 Haul Rd. Wayne, NJ 07470 • P: (800) 631-0442 • customerservice@krowne.com • krowne.com

Due to our commitment to continued product improvement, specifications are subject to change without notice.

Rev. 06/2021 • No. 16-151L