

# ELKAY PRO FILTRATION™ ULTRA CAPACITY

## Manual & Performance Data Sheet



### STOCK UP ON ELKAY PRO FILTRATION™

Elkay Pro Filtration bottle filling stations are compatible only with Elkay Pro Filtration filters.

Replacing filters as recommended gives the added assurance of serving cleaner, safer water.

FOR USE INDEPENDENTLY OR AS STAGE 2 FILTRATION



1-800-834-4816



[elkay.com/filtration](http://elkay.com/filtration)

### RECOMMENDED USE CONDITIONS

System Model	Replacement Element	Working Pressure	Operating Temperature	Flow Rate	Capacity
EWFPRO	FL10	20 – 105 psi (241 – 724 kPa) (1.4 – 7.4 Kg/cm <sup>2</sup> )	40 – 100° F (5 – 38° C)	1.5 GPM (5.7 LPM)	10,000 Gallons (37,854 L) 1 Year Maximum

Certification valid only when the flow through the system does not exceed 1.5 GPM.

This system has been certified by IAPMO R&T to NSF/ANSI 42, 53 and 401 for the reduction of the substances listed below. The concentration of the indicated substances in water entering the system was reduced to a concentration less than or equal to the permissible limit for water leaving the system as specified in NSF/ANSI 42, 53 and 401. This system has also been certified by IAPMO R&T to NSF/ANSI/CAN 372 for lead free compliance.



Certified Contaminants	Influent Challenge Concentration	Maximum Permissible Product Water Concentration
Lead <sup>†</sup>	0.15 mg/L ± 10%	0.005 mg/L
Microplastics	At least 10,000 particles/mL*	≥ 85% reduction
Asbestos	10 <sup>7</sup> to 10 <sup>8</sup> fibers/L; fibers >10 µm in length	99% reduction
Chlorine	2.0 mg/L ± 10%	≥ 50% reduction
Particulate, Class I	At least 10,000 particles/mL*	≥ 85% reduction
Cysts	Minimum 50,000/L	≥ 99.95% reduction
Turbidity	11 ± 1 NTU	0.5 NTU

\*Particulates, Class I and microplastics size: 0.5 to < 1 µm

<sup>†</sup>Soluble and particulate lead

Not all water will contain contaminants listed. Performance will vary depending on local water conditions. While testing was performed under standard laboratory conditions, actual performance may vary. Do not use with water that is microbiologically unsafe or of unknown quality without adequate disinfection before or after the system. Systems certified for cyst reduction may be used on disinfected waters that may contain filterable cysts. Filter installation and usage must comply with filtration regulations and guidelines set by local and state municipalities; only intended to reduce the stated contaminants.

**IMPORTANT NOTICE:** Read this Performance Data Sheet and compare the capabilities of this unit with your actual water treatment needs. It is recommended that, before purchasing a water treatment unit, you have your water supply tested to determine your actual water treatment needs. **PLEASE NOTE:** If this device is not maintained and operated as specified in the owner's manual, there is a risk of exposure to contaminants.

**PLEASE NOTE:** For use on cold water line only. Do not allow installed filter to freeze.

## FILTER REPLACEMENT INSTRUCTIONS

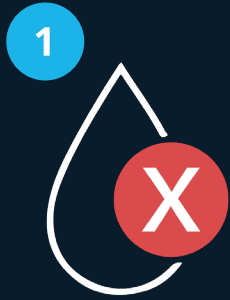

1 Turn off water supply; dispense water to relieve pressure; turn off unit power.

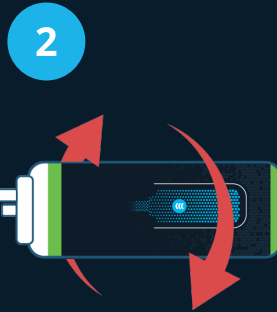

2 Turn used filter(s) 1/4 rotation to remove from filter head.



3 Remove cap from new filter and use to seal used filter.

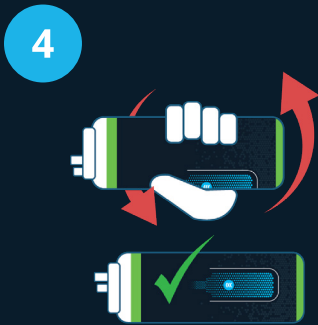

4 Hold filter as shown above. Firmly insert into filter head. Turn filter 1/4 rotation until it locks into place and the front label is clearly visible. Repeat for second filter if equipped.

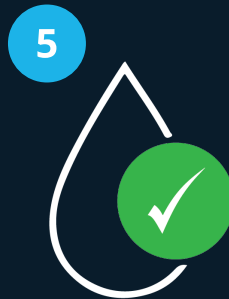

5 Turn on unit power. The display will show a countdown to the start of the filter flush. Turn on the water supply.

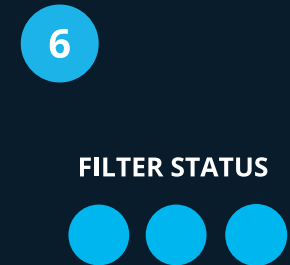

6 After the automatic filter flush is completed, the three filter status LEDs will reset to blue.

### Limited Warranty

This product is warranted to be free from defects in material and workmanship for a period of one year from the date of installation. Warranty is limited to repair or replacement of defective component.

- ▲ WARNING: Cancer and Reproductive Harm – [www.P65Warnings.ca.gov](http://www.P65Warnings.ca.gov)
- ▲ ADVERTENCIA: Cáncer y daño reproductivo – [www.P65Warnings.ca.gov](http://www.P65Warnings.ca.gov)
- ▲ AVERTISSEMENT: Cancer et effets néfastes sur la reproduction – [www.P65Warnings.ca.gov](http://www.P65Warnings.ca.gov)