

ADCRAFT®

HD-26, HD-36, HD-48 Heated Displays Instruction Manual



This manual contains important information regarding your Admiral Craft unit. Please read the manual thoroughly prior to equipment set-up, operation and maintenance. Failure to comply with regular maintenance guidelines outlined in this manual may void the warranty.

Heated Display

Thank you for purchasing this Admiral Craft Heated Display Food Merchandiser. Before operating this unit, please read the following instructions carefully.

 **WARNING**

FIRE, INJURY OR DEATH HAZARD

HAVE THIS EQUIPMENT INSTALLED BY A QUALIFIED INSTALLER IN ACCORDANCE WITH ALL FEDERAL, STATE AND LOCAL CODES. FAILURE TO INSTALL THIS EQUIPMENT PROPERLY CAN RESULT IN INJURY OR DEATH.

 **WARNING**

FIRE HAZARD

THIS UNIT IS DESIGNED TO BE USED WITH LEGS. DO NOT USE WITHOUT LEGS INSTALLED. USE OF THIS EQUIPMENT WITHOUT LEGS CAN CAUSE THE UNIT TO OVERHEAT AND CAUSE A FIRE.

 **WARNING**

FIRE AND BURN HAZARD

FIRE AND BURN INJURIES CAN OCCUR IF THIS EQUIPMENT IS NOT USED PROPERLY. TO REDUCE RISK OF INJURY OR DEATH:

- **Unit should only be used in a flat, level position.**
- **Let hot unit cool before cleaning or moving.**
- **Do not spray controls or outside of unit with liquids or cleaning agents.**
- **Do not operate unattended.**

Function and Purpose:

This unit is intended to be used as a merchandiser for hot food in commercial foodservice operations only. It is not intended for household use.

Before using this equipment it must be cleaned thoroughly. **Clean all surfaces before use.** Failure to clean surfaces before using the unit could cause food contamination.

⚠ WARNING
FIRE, INJURY OR DEATH HAZARD
HAVE THIS EQUIPMENT INSTALLED BY A QUALIFIED INSTALLER IN ACCORDANCE WITH ALL FEDERAL, STATE AND LOCAL CODES. FAILURE TO INSTALL THIS EQUIPMENT PROPERLY CAN RESULT IN INJURY OR DEATH.

Installing the Heated Display

1. Remove all packing material and tape, as well as any protective plastic from the unit.
2. Clean any glue residue left over from the plastic or tape.
3. Place the unit in the desired position and level using the adjustable feet.
4. Installing doors: Note the longer doors are for the front or sloped side and the shorter doors are for the back or straight side. The doors are fitted with the handles facing toward the outside of the unit by placing the top of the door into the top track and sliding the door up to clear and lower into the bottom track.
5. Installing the shelves: Place the uprights into the provided slots making sure that the longer tab is on top and the flat sides face inward. Place the shelf supports at the desired locations and position the shelf on these supports.

Note: The shelf supports and shelves can be positioned level or sloping forward for improved presentation.

6. Plug the unit into a properly grounded electrical supply matching the nameplate rating. Damage to the unit can occur if incorrect power is supplied to unit.

Operating the Heated Display

1. Set thermostat to the desired heat.
2. Preheat the unit for approximately 15 minutes, until the unit reaches set temperature. The pilot light will cycle on and off when the unit is at the set temperature.
3. Use the toggle switch to operate the light.
4. If moisture is required, fill humidity pan with 20 ounces of water and monitor water level.

⚠ WARNING
ELECTRICAL SHOCK HAZARD
DO NOT SPRAY OUTSIDE OF THE UNIT OR CONTROLS WITH LIQUID OR CLEANING PRODUCT. LIQUID COULD ENTER THE ELECTRICAL COMPARTMENT AND CAUSE A SHORT CIRCUIT OR ELECTRIC SHOCK.

Cleaning:

1. Unplug unit and allow to cool completely before cleaning.
2. Do not immerse cord, plug or unit in water or any other liquid.
3. Using a damp cloth or sponge dipped in soapy water clean unit.
4. Wipe the unit dry and wait at least ½ hour before using.

Repair:

There are no user serviceable parts within this food merchandiser. To avoid serious injury or damage, never attempt to repair or replace a damaged power cord yourself. Contact a qualified professional repair service.

PART LIST OF HEATED DISPLAY SHOWCASE

NO	NAME	SPECIFICATION	QTY
1	TOP PLATE	SPRAYED	1
3	WATER PAN		1
4	SCREW	SS, M5X16	6
5	PROTECT PLATE FOR ELEMENT	SS430,T=1MM	1
6	LEVEL PLATE		1
7	SLIDE GROOVE		2
8	ELEMENT	120V/1500W	1
9	SUPPORT FOR ELEMENT	ALLUMINUM PLATED	4
10	SCREW	SS, M4X12	10
11	FLAT WASHER	SS, M4	10
12	SPRING WASHER	SS, M4	10
13	NUT	SS, M4	10
14	POWER CORD & PLUG	2M LONG	1
15	KNOB		1
16	INDICATOR, YELLOW		1
17	POWER SWITCH		1
18	SWITCH, GREEN		1
19	EGO THERMOSTAT	85C	1
20	CONTROL PLATE	STEEL, T=1	1
21	POWER CORD SHEALTH	SR7N-2	1
22	SIDE PLATE		1
23	SCREW	M4X12	6
24	LEG		4
25	BOTTOM HOUSING	SPRAYED	1
26	PRESS PLATE FOR GLASS	SS430,T=1MM	4
27	SCREW	SS, M5X10	4
28	SCREW	M6X20	4
29	FOOT		4
30	NUT	M6	4
31	SUPPORT PLATE FOR ELEMENT	ALLUMINUM PLATED, T=1	1
32	ASSEMBLY PLATE FOR ELEMENT	ALLUMINUM PLATED, T=1	1
33	LEFT SUPPORT RACK	SS430,T=1MM	3
34	ADHESIVE	1.7M	1
35	HANDLE FOR GLASS		2
36	GLASS	T=5MM	2
37	RACK LARGE	A3	1
38	RIGHT SUPPORT RACK	SS430,T=1MM	3
39	RACK MEDIUM	A3	1
40	RACK SMALL	A3	1
41	VERTICAL POST	SS430,T=1MM	4
42	ANGLE POST FOR LAMP	PVC,T=1	1
43	SIDE GLASS	T=5MM	2

PART LIST OF HEATED DISPLAY SHOWCASE

NO	NAME	SPECIFICATION	QTY
44	SCREW		2
45	HANDLE FOR GLASS		2
46	GLASS	T=5MM	2
47	TRANSFORMER		2
48	STARTER		2
49	STARTER BASE		2
52	BODY RACK		1
53	LAMP BASE		4
54	LAMP		2
55	ANGLE POST FOR LAMP	PC, T=1	1

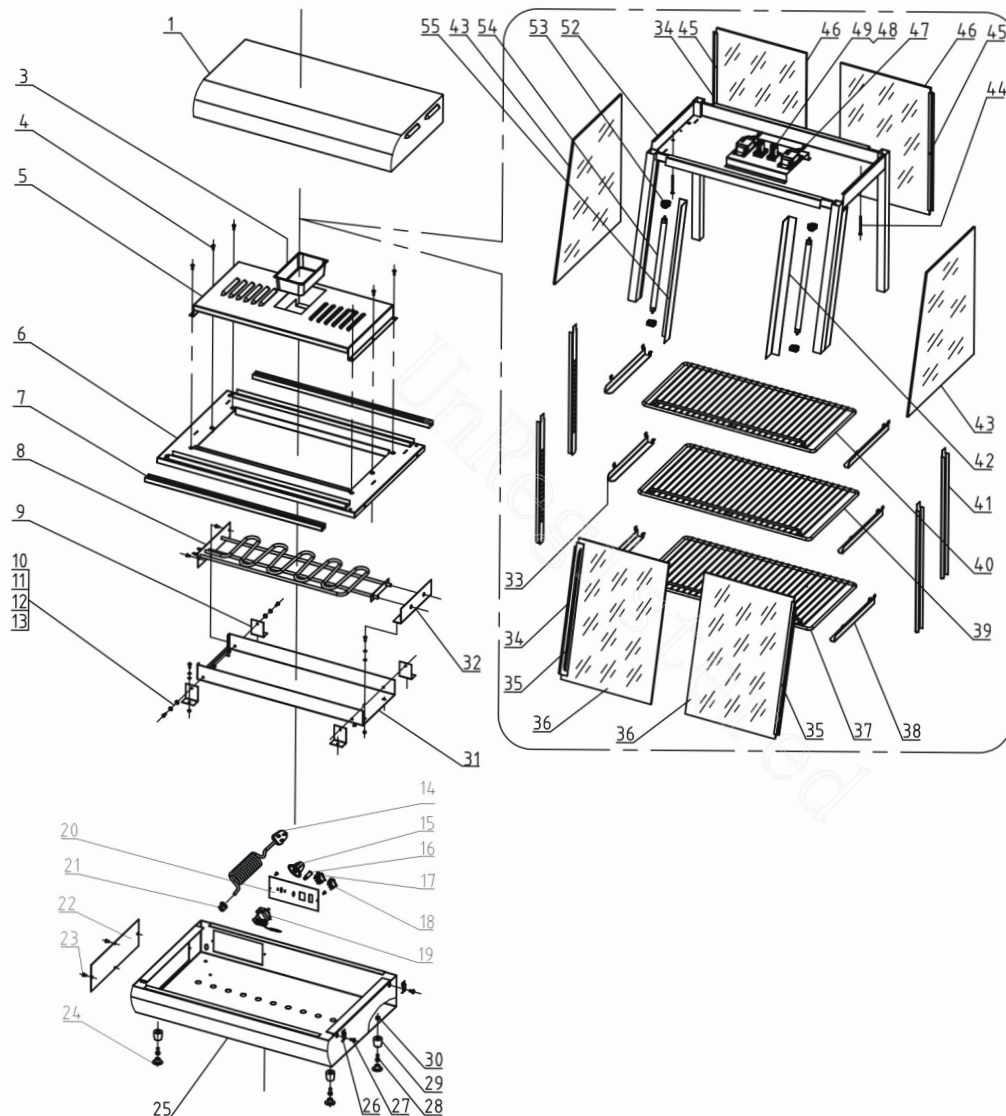



1-YEAR LIMITED WARRANTY

Admiral Craft Equipment Corp. (the "Company") warrants this product (the "Product") will be free from failures in material and workmanship for one (1) year from the date of original purchase with proof of purchase, provided that the Product is operated and maintained in conformity with the Owner's Manual. This Limited Warranty is non-transferable. During this period, your exclusive remedy is repair or replacement without charge of the Product or any component found to be defective at the Company's discretion. If the Product or any component is no longer available, the Company will replace it with a similar one of equal or greater value. This Limited Warranty is void if the Product is used with voltage other than 120 Volts. **THIS WARRANTY IS IN LIEU OF ALL IMPLIED WARRANTIES, INCLUDING WARRANTIES OF MERCHANTABILITY, FITNESS FOR A PARTICULAR PURPOSE, PERFORMANCE, OR OTHERWISE, WHICH ARE HEREBY EXCLUDED. IN NO EVENT SHALL THE COMPANY BE LIABLE FOR ANY DAMAGES, WHETHER DIRECT, INDIRECT, INCIDENTAL, FORSEEABLE, CONSEQUENTIAL, OR SPECIAL ARISING OUT OF OR IN CONNECTION WITH THIS PRODUCT INCLUDING DAMAGES ARISING FOR FOOD OR BEVERAGE SPOILAGE CLAIMS.**

You may have other legal rights depending upon where you live. Some States or Provinces do not allow limitations on warranties so the foregoing may not apply to you.

WARRANTY EXCLUSIONS

IMPROPER ELECTRICAL CONNECTIONS:

The Company is not responsible for the repair or replacement of failed or damaged components resulting from electrical power failure, the use of extension cords, low voltage, or voltage spikes to the Product.

IMPROPER USAGE:

This Limited Warranty does not cover failure or other damages to the Product resulting from (i) improper usage or installation or failure to clean and/or maintain the Product as set forth in the Owner's Manual; or (ii) accident, misuse, abuse, negligence, or modification or alteration of the Product.

CONSUMABLES:

This Limited Warranty does not include consumables or wear-and-tear items such as legs, feet, plastic component parts, splash shields, filters, gaskets, and non-stick cooking surfaces.

ADJUSTMENTS & CALIBRATIONS:

Leveling, tightening of fasteners, or utility connections normally associated with the original installation are the responsibility of the dealer, installer, or the end user and not the responsibility of the Company and will not be considered warranty issues.

If you think the Product has failed, or requires service, within its warranty period, please contact the Company's Customer Care Department through our website at: www.admiralcraft.com "Service" --> "Technical Support Request". A receipt proving the original purchase date will be required for all warranty claims, handwritten receipts are not accepted. You may also be required to return the Product for inspection and evaluation. Return shipping costs are not refundable. The Company is not responsible for returns lost in transit.

This Limited Warranty is Valid only in the USA and Canada.