

Jackson

WAREWASHING SYSTEMS

INSTALL GUIDE



XL-E-LTH
 Understand Step 14
 before proceeding!
 ¡Entender el paso 14
 antes de continuar!
 Comprendre l'étape 14
 avant de commencer !

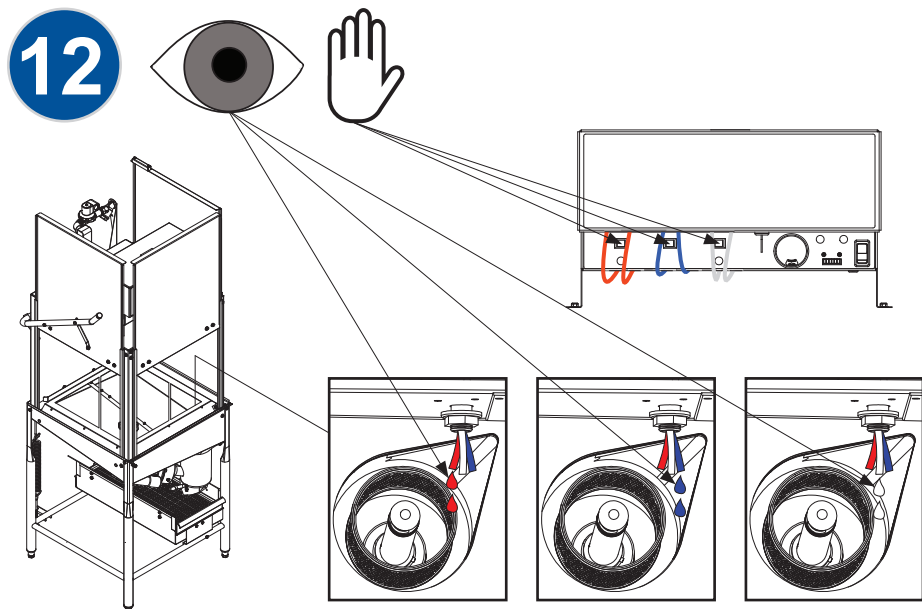
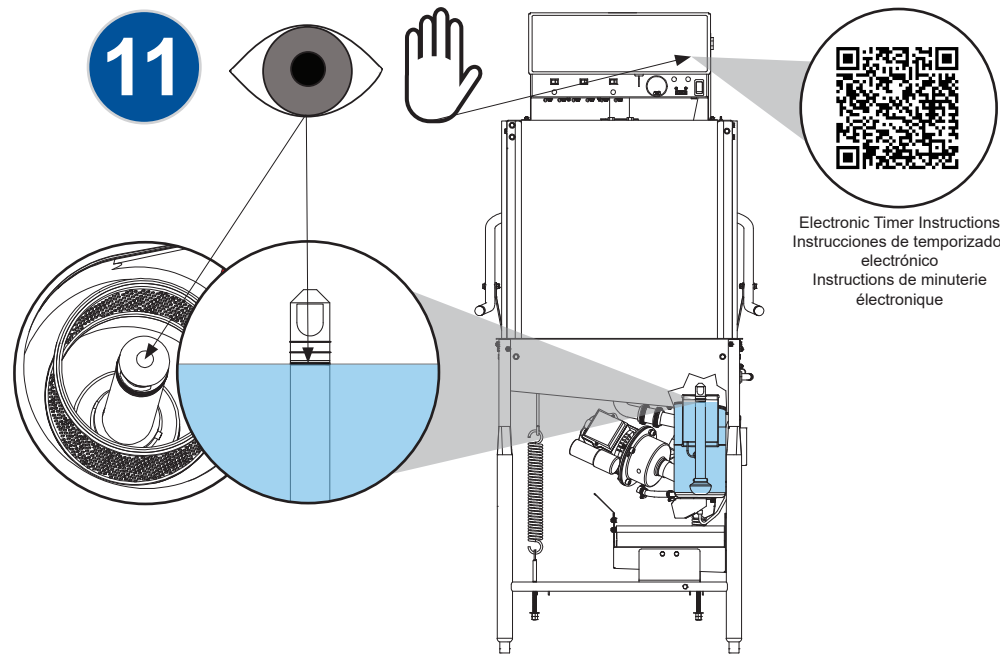

1.888.800.5672
www.jacksonwvs.com

CONSERVER SERIES DOOR-TYPE DISHMACHINES

- = risk of electric shock / riesgo de electrocución / risque de décharge électrique
- = caustic chemicals / químicos cáusticos / produits chimiques caustiques
- = ground wire / cable a tierra / fil de terre
- = verify / verificar / vérifier
- = use fingers/hands / utilizar los dedos/manos / utilisez vos doigts/mains
- = use eyes / utiliza tus ojos / utilisez vos yeux
- = reference data plate / mire la placa de datos / regarder la plaque signalétique
- = water / agua / eau
- = not supplied / no se suministra / non fourni
- = 3-Phase / Trifásica / Triphasée
- = on / encendido / allumé
- = off / apagado / éteint

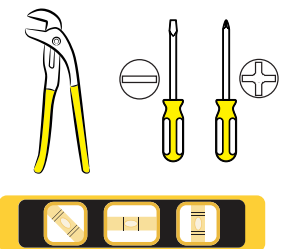

CONSERVER® XL-E SERIES/XL HH

